

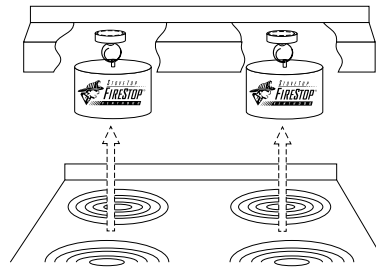

P/N 675-3-115E



Designed and manufactured by Williams-Pyro, Inc., Fort Worth, TX, USA.

© 2011, Williams-Pyro, Inc. All rights reserved.

Williams-Pyro, StoveTop FireStop, and the StoveTop FireStop logo are either registered trademarks or trademarks of Williams-Pyro Incorporated in the United States and/or other countries.

Model No. 675-3. Under U.S. Patents 5,518,075; 7,472,758; etal/Foreign Patent 1,334,741.

Installation Instructions

Parts Included

A Canister (x2)



B Magnet Assembly (x2)



Optional Parts

C Steel Washer (x2)



D Adhesive Disc (x2)



If missing any parts, please contact your supplier. Not drawn to scale.



Warning

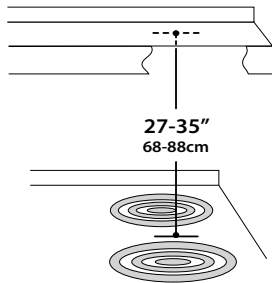

27-35"
68-88cm

There must be 27-35" (68-88cm) between the surface of your cooktop and the mounting point in the vent hood.

NOT FOR DEEP FAT FRYING

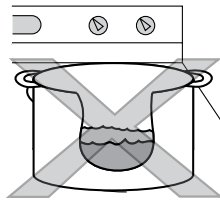

Not intended for use with deep fat frying.

GREASE FIRES MAY SPLASH

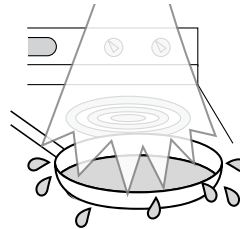

When activated, falling powder may cause grease fires to splash.

TURN OFF STOVE (if it is safe to do so)



If the heat source is not immediately shut off after discharge, the fire may re-ignite.

How It Works

1

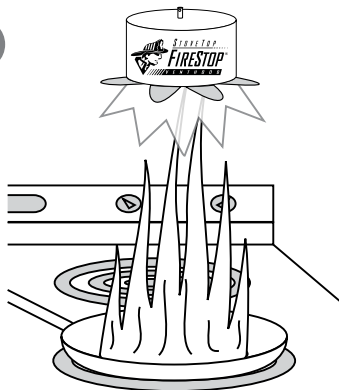

When the flame touches the bottom of the canister, the actuator opens the petals of the canister.

2

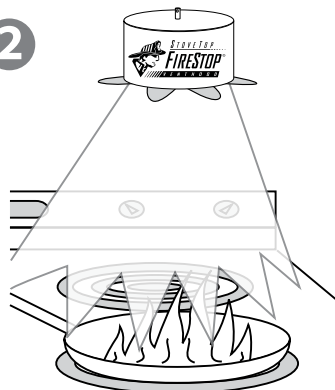

Powder drops out of the canister and onto the fire. **Caution:** Open petals are sharp.

3



The powder suppresses the fire. If it is safe to do so, turn off the heat source to prevent the fire from re-igniting.

Installation Instructions

1

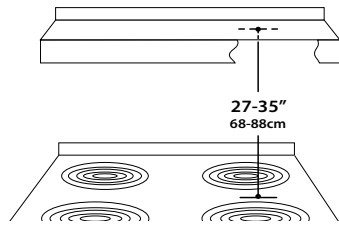

Confirm you have 27-35" (68-88cm) of clearance between the surface of your cooktop and the mounting point in the vent hood.

2

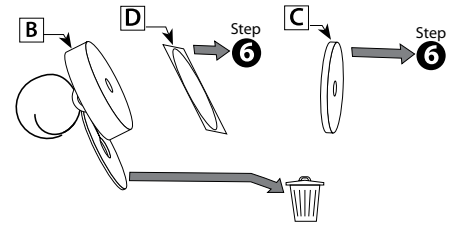

Remove spacer and discard. Remove washer [C] and adhesive disc [D] from magnet [B] (if included) and set aside.

3

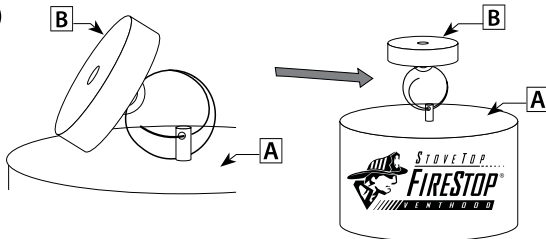

Insert end of ring attached to magnet [B], through hole in pin at top of the canister [A]. Rotate ring approximately one half-turn.

4

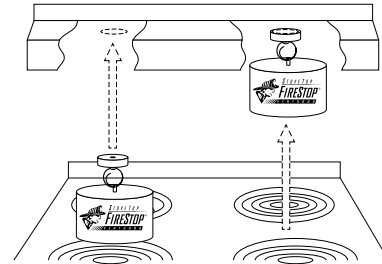

Center canisters on the cooktop between front and back burners. Raise canister by magnet to spot directly above in vent hood. If unit remains attached, installation is complete.

Follow steps 5-8 if the magnet does not attach

5

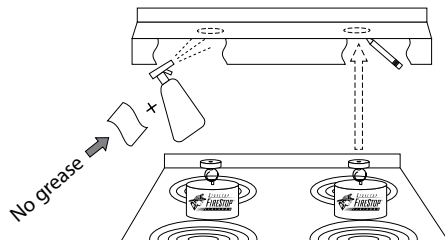

Clean area in vent hood where both magnets will attach. Locate and mark these spots. The area should be completely dry and free of grease.

6

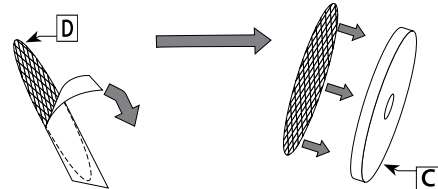

Clean and dry one side of washer [C]. Peel backing from adhesive disc [D]. Align and press exposed adhesive to washer.

7

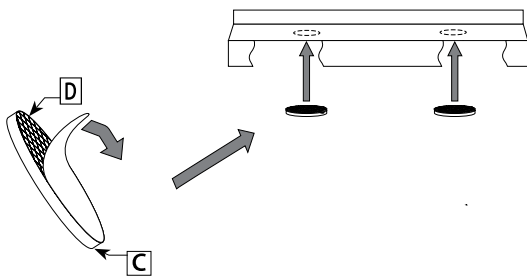

Peel backing from other side of adhesive disc. Firmly press exposed adhesive side of washer to spot marked in vent hood.

8

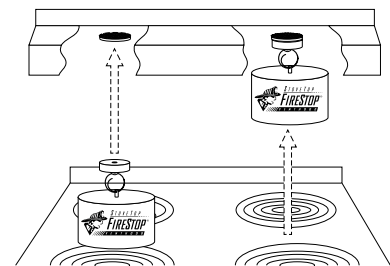

Once washers are firmly attached in vent hood, attach magnet directly to washer. Installation is complete.

Important Information

- Users must follow all instructions for StoveTop FireStop Venthood to function properly.
- Each unit must be replaced by the date on the label or after activation.
- For residential vent hoods only.
- Units do not need to be recharged or inspected by a fire service professional.
- For storage and disposal information, visit our website at www.StoveTopFireStop.com.
- Active ingredient: WPI BC, Bicarbonate of Soda.